

# *ASTA/NJ Chamber Music Institute at Kean University*



*Session I: July 25– 31, 2010*

*Session II: August 1-7, 2010*

July 9, 2010

Dear ASTA/NJ Chamber Music Institute Parents and Students,

I hope you are having a wonderful summer! We are very excited about this year's ASTA/NJ Chamber Music Institute and are thrilled to have you onboard as a participant. Two important items:

- **Please provide me with any updates to your contact information.** ASTA/NJ CMI must know how to reach parents of students during the period of time students are participating in our program.
- **If you have not sent the balance of your tuition, please do so at your earliest convenience!** Please make checks payable to ASTA/NJ CMI. Please mail payment to me at **25 Lowell Avenue / Summit, NJ 07901.**
- Please note that **all performances – student and professional – are open to the public and will be held in Kean University's stunning new recital hall – Eugene & Shelley Enlow Hall. Professional concerts are \$10 general admission; \$5 students/seniors/Kean University community. Student performances are free of charge.** See list of links at bottom of this document for information about CMI concerts.

Here is some very important information concerning ASTA/NJ CMI 2010 – please take time to read this email and to follow links to important information!

## **Registration:**

- **Session I: 2-3pm, July 25, 2010 in Wilkins Theatre Building Room PA 120. Watch for signs designating where to enter building.**
- **Session II: 2-3pm, August 1, 2010 in Wilkins Theatre Building Room PA 120. Watch for signs designating where to enter building.**
- **PARKING FOR REGISTRATION: park in lot in front of Wilkins Theatre building (see attached campus map).**
  - enter Kean University from Morris Avenue (not from Green or North Avenue)

- You will come to a 'T' – (The Wilkins Theatre building is in front of you, slightly to the right, it is clearly labeled) go right.
  - Follow signs to 'ASTA/NJ CMI Registration'
  - Enter Wilkins Theatre building through designated doors. Watch for ASTA signs to guide you.
  - Do not unload your belongings until you are at the dormitory. Wilkins Theatre is for registration only.
- **Dormitory Check in at the New Freshman Dormitory** will immediately follow registration and will conclude at 3:30pm. Anyone anticipating difficulty in arriving on campus in time to register and check in to the dormitory should contact Christopher Kenniff to discuss making arrangements to register and check in to the dormitory.
    - Following registration, a very short drive will take you to the Vaughn Eames parking lot
    - Unload belongings at Vaughn Eames parking lot **\*\*\*bring small cart for transporting heavy items as some walking is required; cars may NOT pull directly up to the dorms due to parking regulations on campus.**

### Maps and Directions

- These maps are **essential – download and print them out:**
  - ✓ <http://www.kean.edu/directions.html>
  - ✓ <http://www.kean.edu/campusmap.html>
  - ✓ <http://www.kean.edu/~keangrad/About-Us/Directions.html#> (directions to Enlow Hall)
  - ✓ NOTE: students will receive copies of campus maps that highlight the specific buildings we will use in their registration packets.

### Dormitory & CMI Essentials

- **REMINDER: Don't forget your music essentials:**
  - ✓ Shoulder strap or wheels for carrying instruments to rehearsal spaces/performances
  - ✓ foldable music stand
  - ✓ student concert attire (black pants/skirt/dress & white shirt/blouse)
  - ✓ nice clothing for Thursday's feature concert (this is a formal recital event open to the public so bring nice clothing)
  - ✓ pencils, staff paper, notebook
  - ✓ recording device (if you have one)
  - ✓ See **Dormitory Check List** and **CMI 2010 FAQ** documents accompanying this email for more information.

- Take a look at the Kean University Office of Residence Life website floor plan for **the new Freshman Dormitory** ([http://www.kean.edu/~reslife/pros\\_halls.html](http://www.kean.edu/~reslife/pros_halls.html)). This is where students will be housed.
  - ✓ The Freshman dorm has 'round the clock security; ID supplied by Kean University at registration is required for entrance at all times.
  - ✓ Along with your ID, you will receive a wifi access code. Anyone wishing to connect to the internet using a cable must bring their own cable.
  - ✓ Students will be grouped by 1) gender 2) age. We will attempt to accommodate specific roommate requests.
- **FOOD IN DORMITORY ROOMS:** Many people enjoy the flexibility of having their favorite foods available to them at any time. Please be aware of the following:
  - ✓ Your 'fridge is **not** full-sized. There is a small fridge (microfridge: small fridge with attached microwave) in each bedroom shared by two people; consider bringing a minimum of food items that will need to be kept cold. For those who participated in CMI in past years, please be aware that the dorm fridges are much smaller than in past years.
  - ✓ Mirwaves are available in each room as mentioned above.
  - ✓ You will need to bring your own plates, utensils, paper towels/napkins, cups, etc...
- Reading lamps are not necessary for the dorm rooms. They were necessary in past years but are not needed in the new dormitory.
- New Freshman Residence Hall: Each bedroom contains two beds, two closets, two desks, two desk chairs, and one small refrigerator (microfridge).

Room 16'6" x 11'  
Bathroom 7'4" x 6'

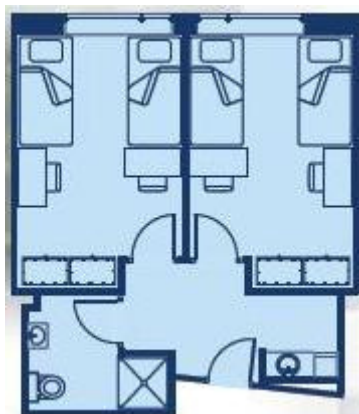

### Gourmet Dining Services

- Visit GDS' website if you wish:  
<http://www.gourmetdiningllc.com/campus/kean/index.php>
- Students will eat in the University's primary cafeteria located in University Center Building.
  - ✓ Students will enter cafeteria using their ID supplied at registration and will use a food voucher at meal time.

- All student meals in the cafeteria are already paid for as part of your tuition
- Please see FAQ for more about food service & on campus concessions

#### **LISTING OF LINKS FOR ASTA/NJ CMI 2010:**

While I love that so much can be done via email, it can be confusing to keep track of all of the links to this and that. Here is a list of links referenced above that will be helpful to you.

- DIRECTIONS:
  - ✓ <http://www.kean.edu/directions.html>
  - ✓ <http://www.kean.edu/campusmap.html>
  - ✓ <http://www.kean.edu/~keangrad/About-Us/Directions.html#> (directions to Enlow Hall)
  - ✓ NOTE: students will receive copies of campus maps that highlight the specific buildings we will use in their registration packets.
- CAMPUS MAP: <http://www.kean.edu/campusmap.html>
- DIRECTIONS TO ENLOW RECITAL HALL: <http://www.kean.edu/~keangrad/About-Us/Directions.html#>
- CMI WEB PAGE <http://www.astanj.com/chambermusic.php>
  - ✓ The following items (and more) are available on our web page:
    - DAILY SCHEDULE for Sessions I & II
      - <http://www.astanj.com/chambermusic.php> (see 'Learn More' column on right hand side of page)
    - CMI FAQ
    - CMI FREE ELECTIVES & PRIVATE LESSONS
    - CMI SPECIAL PRESENTATIONS
    - CONCERTS AT CMI

#### **ADDITIONAL MUSICAL INSTRUCTION AVAILABLE AT CMI (ENCOURAGED BUT NOT REQUIRED)**

**PLEASE CONSIDER SIGNING UP FOR ONE OR ALL OF THE FOLLOWING:**

##### **Private Instrumental Lessons**

- Private instrumental lessons are available at the added cost of \$70 per hour. You may sign up for lessons at registration; please bring your checkbook as you will be asked to write a check to the private instructor at the time you sign up. Lessons will be arranged by the private teacher on Monday 7/26/2010 for session I or on Monday 8/2/2010 for session II.

**Composition Instruction with Paul Mack Somers** (renowned composer, critic for the Star Ledger and director of the Classical New Jersey Society) is available. Details are as follows:

- ✓ Beginning Composition teaches elementary motivic writing to students in small group sessions (assuming enough interest to form a class). Student composers write music with the goal of presenting it during the final week of the program as

performed by their peers. Times to be arranged with Maestro Somers. These classes are additional to the curriculum and are available at a rate of \$40 for one session or \$75 for two sessions. Please sign up at registration.

- ✓ Intermediate through Advanced Composition is taught in private lesson format; sign up at registration. Composition lessons are additional to the CMI curriculum and are billed at a rate of \$70.00 per hour.

Looking forward to meeting, hearing and working with all of you! Please feel free to contact me (info in signature below) if I can be of assistance to you in any way.

Sincerely,

## **Christopher Kenniff**

Concert Artist Faculty, Kean University

Director, ASTA/NJ Chamber Music Institute 2010

[www.ChristopherKenniff.com](http://www.ChristopherKenniff.com)

[c.kenniff@comcast.net](mailto:c.kenniff@comcast.net)

[cmkgtr@yahoo.com](mailto:cmkgtr@yahoo.com) – best email to use during CMI.

908.656.1548 – this is my cell phone, feel free to contact me!